

### Angled Shelf Holder Installation

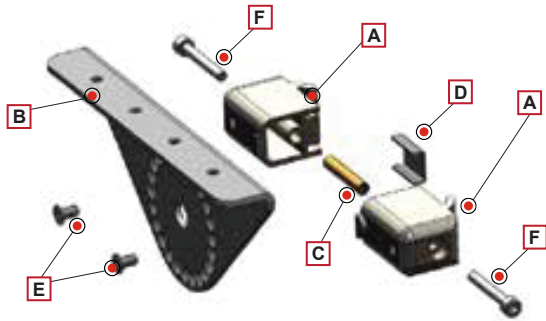

- A** x 4 Shelf brackets
- B** x 1 Shelf hangers
- C** x 2 Brass cylinders
- D** x 2 Anti scratch plates
- E** x 4 Countersunk screws M4 x 10mm
- F** x 4 M4 x 25mm screws

1. Insert brass cylinder **C** in place between the two of the shelf brackets.
2. Insert anti-scratch plate **D** between the pair of shelf brackets **A**
3. Fasten brackets **A** together using 2 of the M4 x 25mm screws **F** on either side of the brackets making sure they are clamped tightly together and positioned at the right height
4. Place the shelf hanger **B** onto the round disc on the bracks and adjust required incline
5. Fasten the shelf hanger **B** with x 2 countersunk M4 screws **A**
6. Set the wooden board over the shelf hanger **B** fixing the board to the hanger through the **F** allocated screw holes

#### Eureka SLIM Angled Shelf Holder

Item Description	Part#
Anodized Aluminum	035-3428-AN
Matte Black	035-3428-MB

