

Top Stays SQ Push

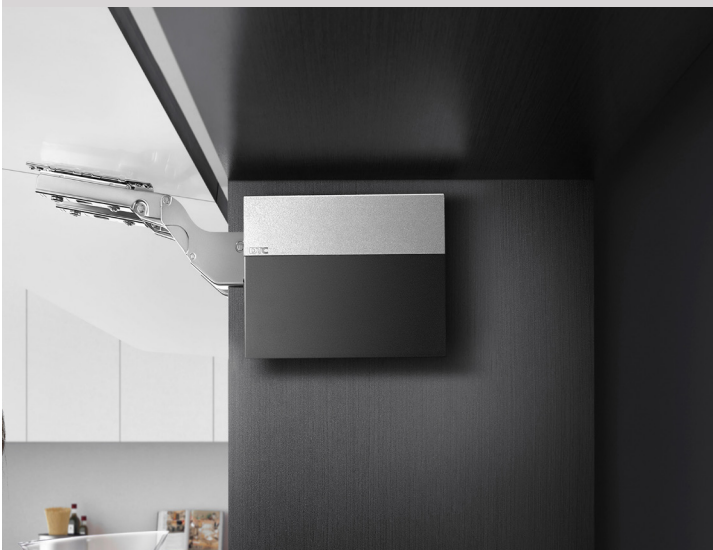

Product Features

The Top Stays SQ Push Series' high-quality construction is matched by its ease-of-use, making this push-to-open lift system an ideal choice for upper cabinets in modern, handle-less kitchens.

- Easy push-to-open
- No additional hinges or handles required
- Opening angle: 107°
- Three way adjustable door positioning
- Tool free assembly and removal
- Third Party Certified for 60,000 cycles
- Stays at any opening position
- 6 cover cap options
- Option: Aluminium door or narrow frame
- Option: 75° and 100° angle restrictors available

Top Stays SQ Series Push Systems

Description	Part#
Top Stays Lift System 580-1350PF Light Weight Push-open	105-SQ02P-AL
Top Stays Lift System 1060-2450PF Medium Weight Push-open	105-SQ02P-AM
Top Stays Lift System 1800-4000PF Heavy Weight Push-open	105-SQ02P-AH
Top Stays Lift System 2600-5000PF Extra Heavy Weight Push-open	105-SQ02P-AEH

Cover kit for SQ series (sold separately)

Description	Part#
Left/Right Cover kit for SQ Push-open White	105-SQJSP-W
Left/Right Cover kit for SQ Push-open Grey	105-SQJSP-DG
Left/Right Cover kit for SQ Push-open White/Light Grey	105-SQJSP-WG
Left/Right Cover kit for SQ Push-open Grey/Anthracite Grey	105-SQJSP-GDG
Left/Right Cover kit for SQ Push-open White/Nickel Plated	105-SQJSP-WN
Left/Right Cover kit for SQ Push-open Grey/Nickel Plated	105-SQJSP-DGN

Power Factor Calculation

Power Factor LF=
Cabinet height KH(mm) x door weight including
double handle weight (kg)

Top Stays SQ Push CALCULATOR:

Calculate your Top Stays SQ Push Power Factor:



<http://mfh.to/SQPush>



Kit package Item No.	Dynamic	Power factor LF	Cabinet Height KH
105-SQ02P-AL	Light	580-1350	250-400mm
105-SQ02P-AM	Medium	1060-2450	250-500mm
105-SQ02P-AH	Heavy	1800-4000	250-500mm
105-SQ02P-AEH	Extra Heavy	2600-5000	350-600mm

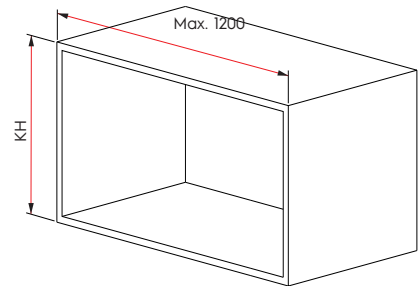

What's In The Box

1. x2

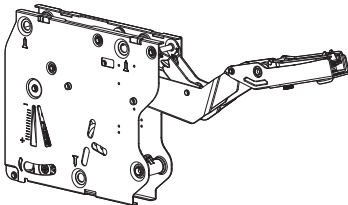

2. x2

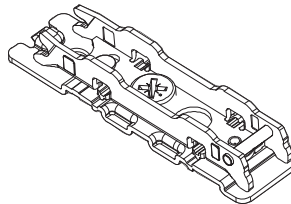

3. x2

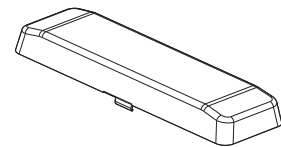

4. x1

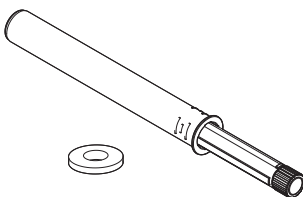

5. x1



#8 x 5/8 in

6. x1



#8 x 1-1/2 inch



Peg Position & Space Requirements

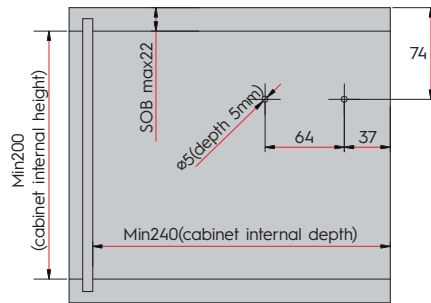

Peg position and space requirement

SOB top panel thickness

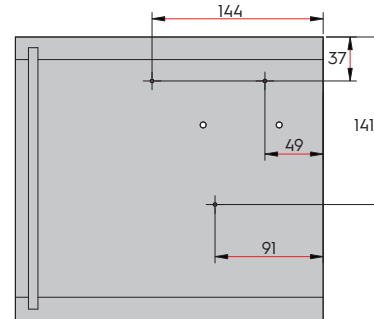

Fixing Position

3x wooden screws #8 x 1-1/2 inch

Door Assembly - Wood & Aluminum Doors

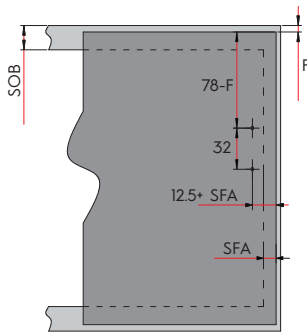

Door Assembly- wooden doors and wide alu frames

4 wooden screws for wooden doors (#8 x 1-1/2 inch)
SFA door overlay of the side panel
Fgap

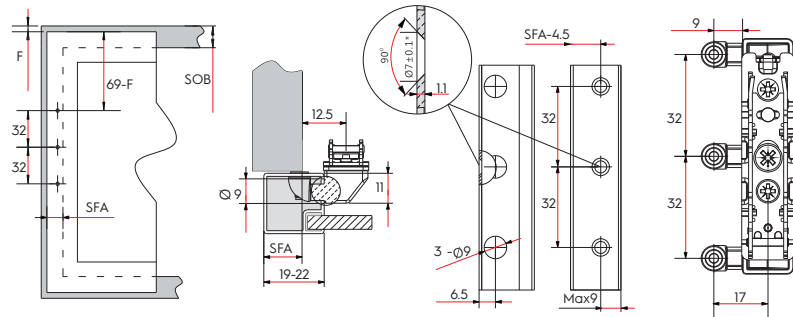

Door Assembly- narrow alu frames

Frame width (mm)	19	20	21	22
SFA(mm)	15 - 19	16 - 20	17 - 21	18 - 22

10 countersunk screws for narrow alu frames (CD3.5X8.5mm)
*When changing material thickness, adjust the assembly dimensions accordingly

Crown Moulding Clearance

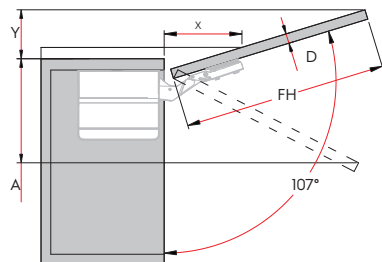

Cornice/crown moulding clearance

D(mm)	16	19	22	26	28
X(mm)	70	58	49	35	26
Limiter Item No.	Opening angle stop		Space requirement (mm)		
/	Without		Y=FH x 0.29-15* D		
105-SGW100	100°		Y=FHx0.17 -15*D		
105-SQW75	75°		A=FH x 0.26*15-D		

Minimum Gap

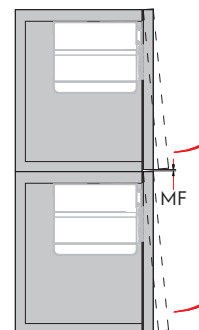

Minimum gap

MF Minimum gap 2mm



Cabinet Assembly

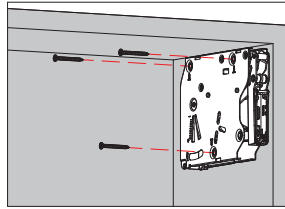

Assembly

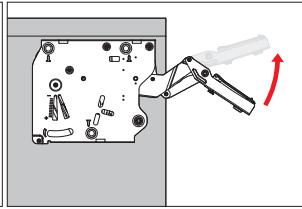

Caution when opening arm

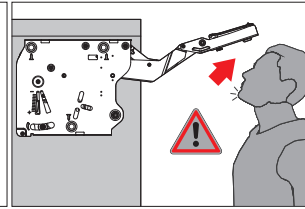

The arm of this device could spring up and cause injury. Do not push the arm down without door attached.

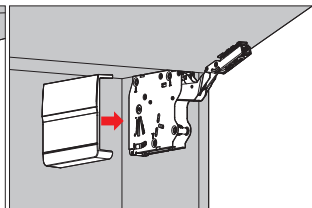
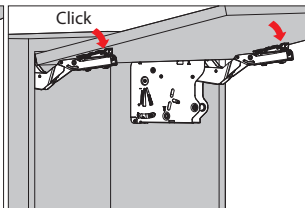
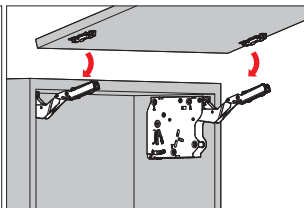
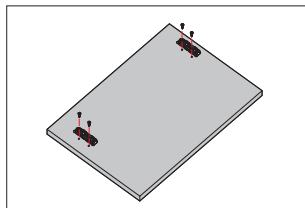

Hovering Adjustment

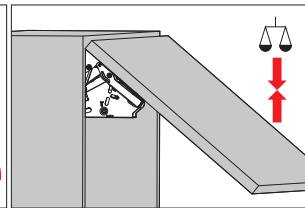
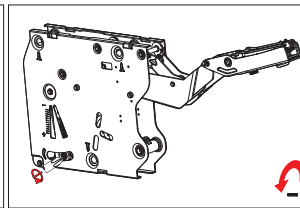
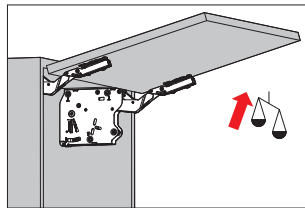
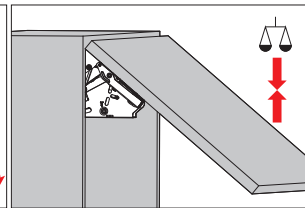
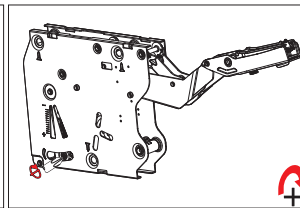
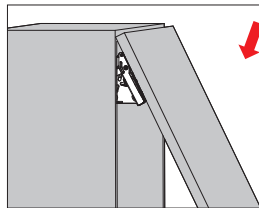

Door Position Adjustment

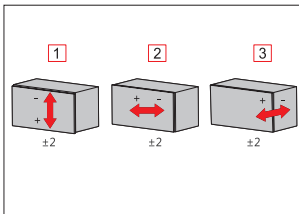
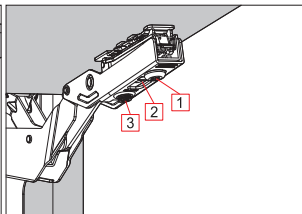
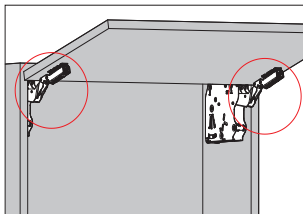

- 1 Height Adjustment: +/- 2mm
- 2 Side Adjustment: +/- 2mm
- 3 Depth Adjustment: +/- 2mm

Removal

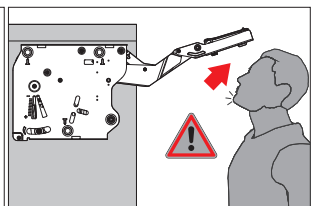
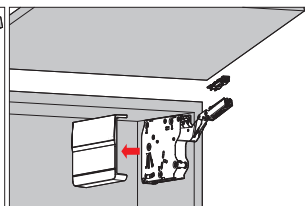
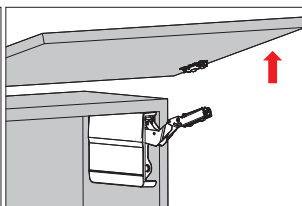
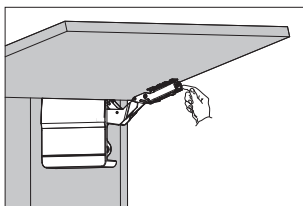

The arm of this device could spring up and cause injury. Do not push the arm down without door attached.



Drill-In Magnetic Push Latch Installation Dimensions (mm) (Included)

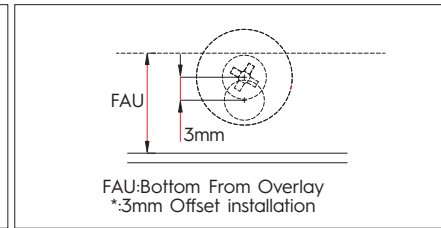
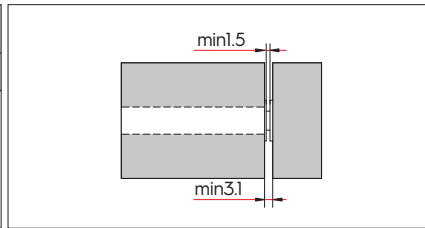
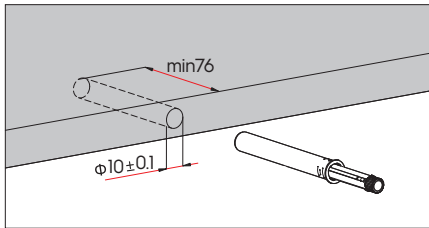

Assembly

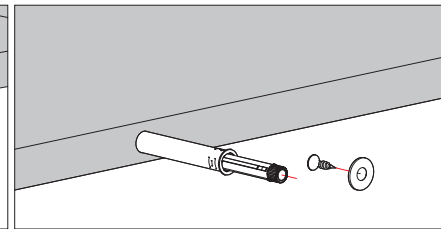
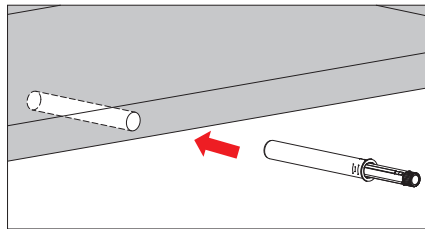

Magnetic Push Latch with Inline Fixing Plate (mm) (Sold Separately)

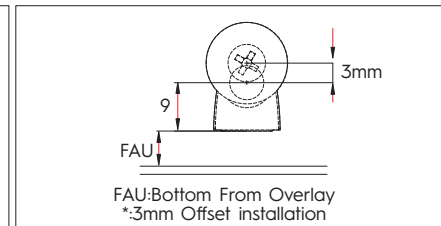
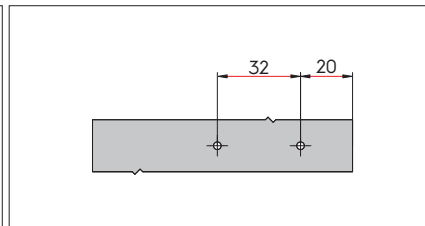
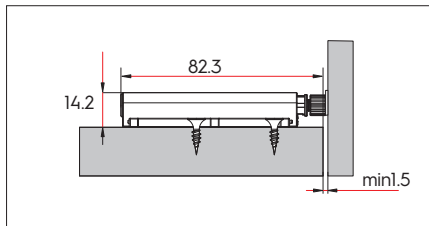

Assembly

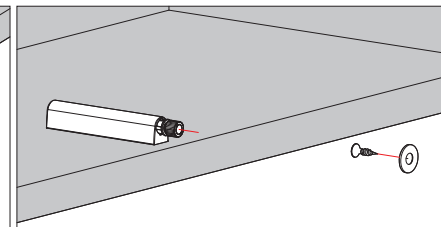
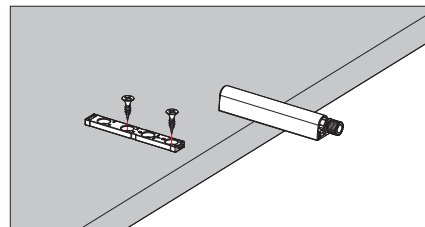

Magnetic Push Latch with Cross Fixing Plate (mm) (Sold Separately)

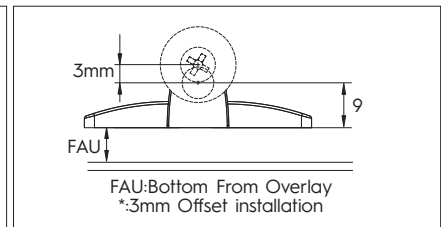
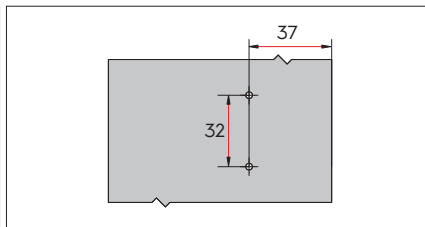
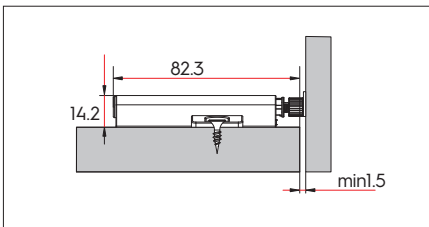

Assembly

