

Salice Progressa



Product Features

Progressa is the next generation of undermount drawer slides from Salice, the innovative Italian manufacturer. Ideal for every drawer in the home, it offers smooth operation and daily reliability. Whether in the kitchen, bathroom, or bedroom, Progressa ensures a seamless experience with its advanced design and superior functionality.

- Full-extension, soft-close undermount, featuring the S-Drive synchronized rack and pinion mechanism
- Available in 5 lengths: 350mm - 550mm
- Tool free side adjustments: +/- 1.5mm, depth adjustments: +/- 3mm, height adjustments: +2.5mm and optional tilt adjustment: +3mm
- Elongated holes for added depth and height adjustment
- Dynamic load capacity: 45kg (100lbs)

What's In the Box

- Set of left and right side slides
- Sold Separately - Front fixing brackets
- Optional:
 - Tilt adjustment levers
 - Push synchronizer kit



Progressa+ Ordering Guide

Length	Part#	Qty/Box
350mm	SG5E6350XXF6	6
400mm	SG5E6400XXF6	6
450mm	SG5E6450XXF6	6
500mm	SG5E6500XXF6	6
550mm	SG5E6550XXF6	6

Accessory Ordering Guide

Part#	Description	Qty/Box
SAFCEX56B	Salice F45/F70 Narrow Clip L/R	pair
SAFCGX43B	Salice F45/F70 Clip Vertical Mount L/R	pair
SAFCGXX3B	Salice F45/F70 Clip Standard Mount L/R	pair
SAGLRXX3F	Salice F45/F70 Tilt Adjustment Lever L/R	pair
SSGD704UGXA	Salice F45/F70 Narrow Clip Drilling Template	1
SASGD704U3XA	Salice F45/F70 Standard Clip Drilling Template	1

Mounting Full-extension Slide on the Cabinet Side

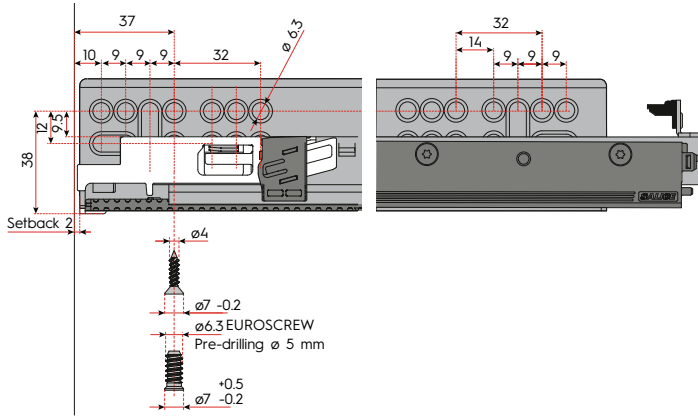

Drilling Pattern

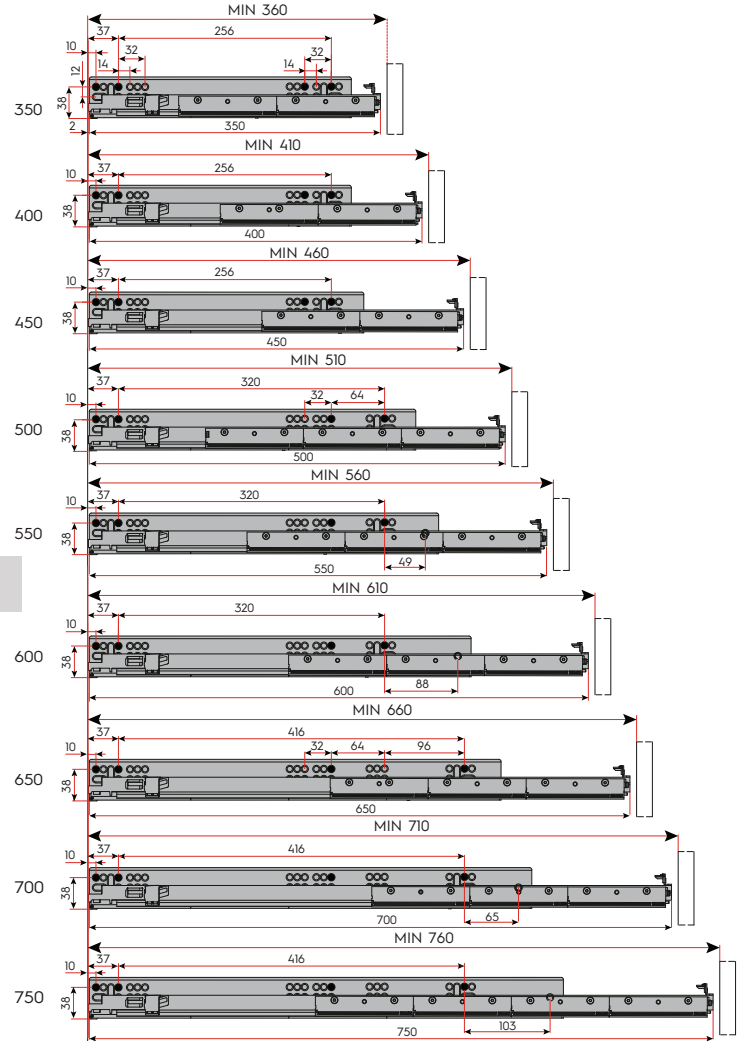

Elongated Hole (additional height and depth adjustment)

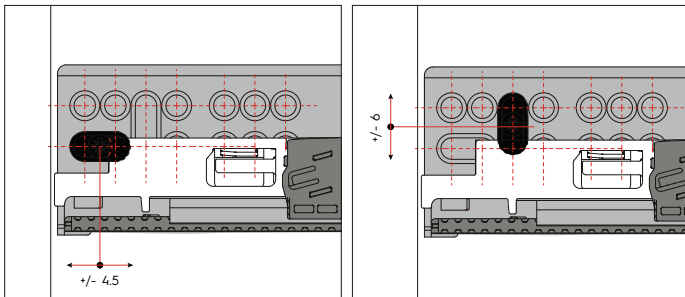

Installation Dimensions

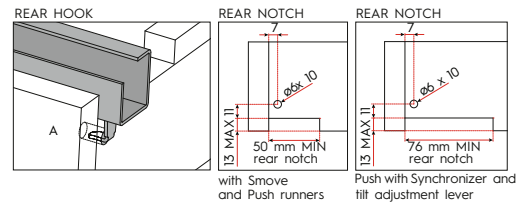
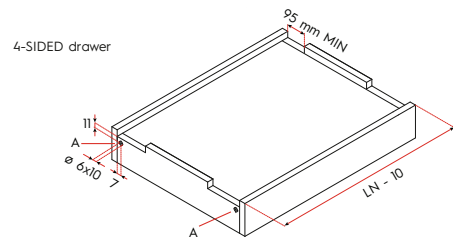
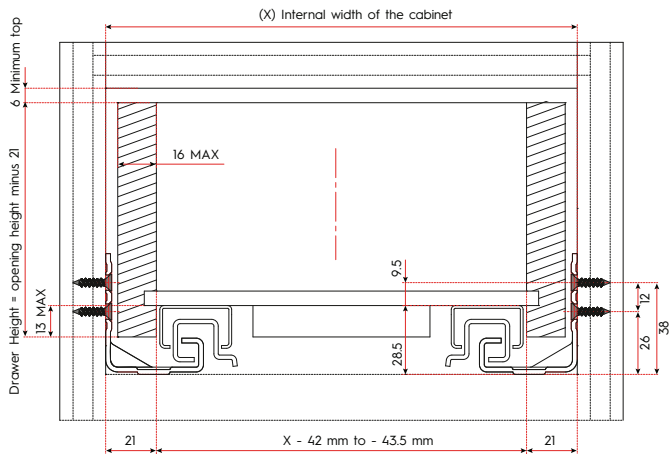

Side Adjustment +/- 1.5mm

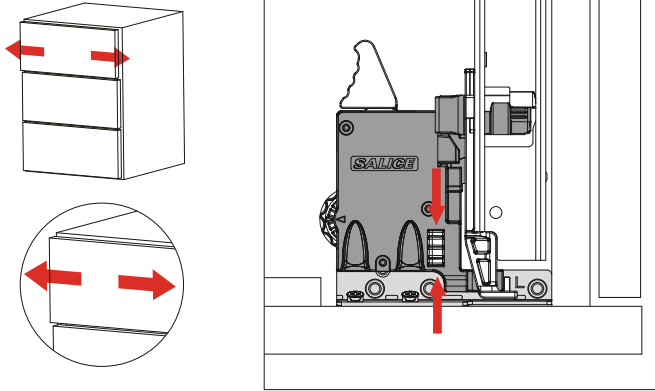

Rotate the white wheel towards the drawer front to adjust left.
Rotate the white wheel towards the drawer back to adjust right.

Depth Adjustment +/- 3mm

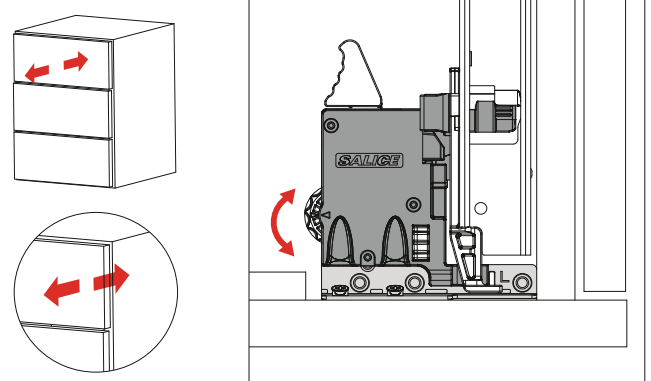

Rotate the white wheel towards the outside of the drawer to increase the gap between the drawer front and gable.
Rotate the white wheel towards the inside of the drawer to reduce the gap between the drawer front and gable.

Height Adjustment +2.5mm

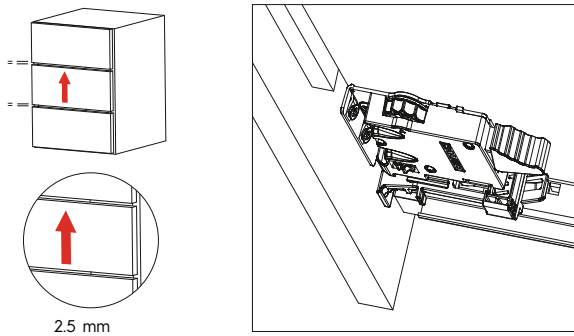

2.5 mm

Push the lever towards the inside of the drawer to adjust height.
This operation is tool free.

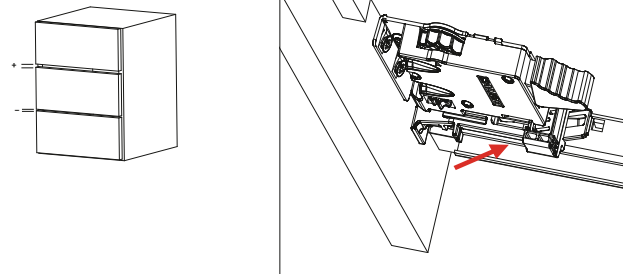

Tilt Adjustment +3mm

Open the drawer and press the lever to adjust tilt.
This operation is tool free.

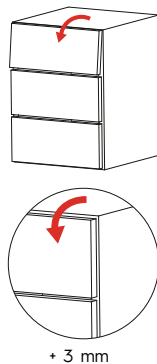

+ 3 mm

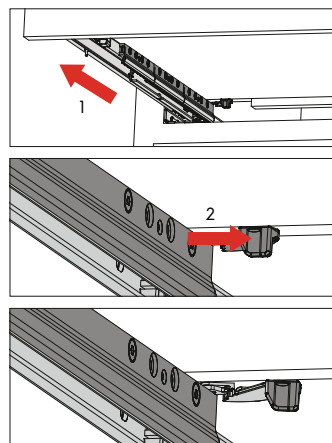

Drawer Assembly & Removal

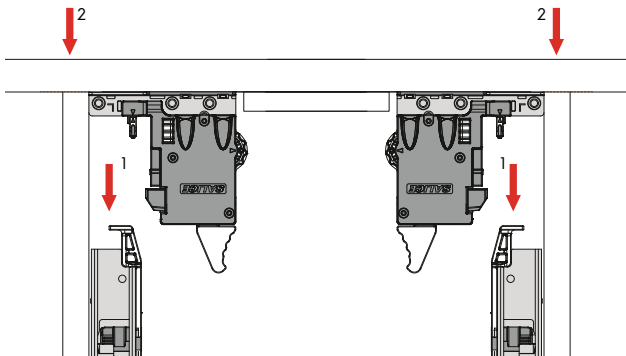
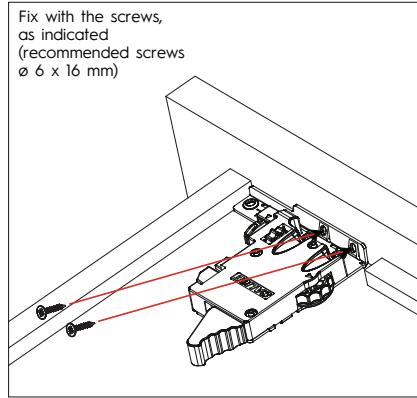
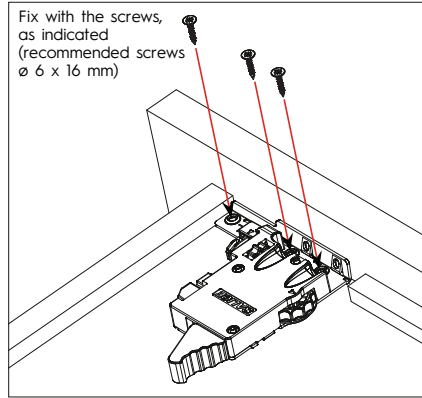

Drawer Assembly

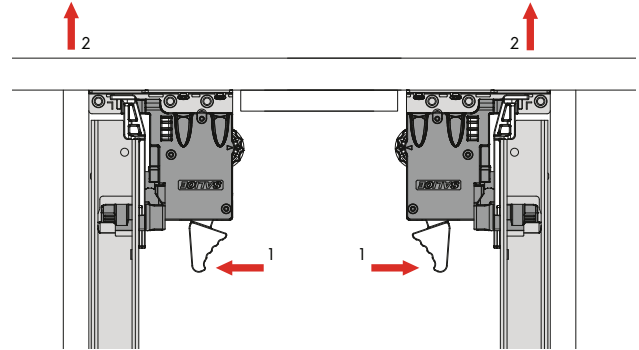

Drawer Removal

Assembly of Tilt Adjustment Lever (Optional)

Pull out the drawer and remove the plastic insert

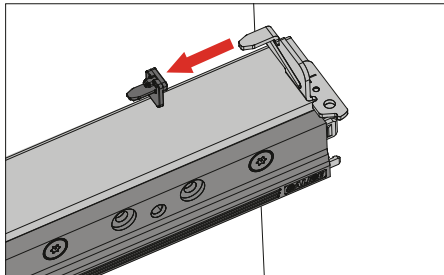

Insert the tilt adjustment levers, both right and left

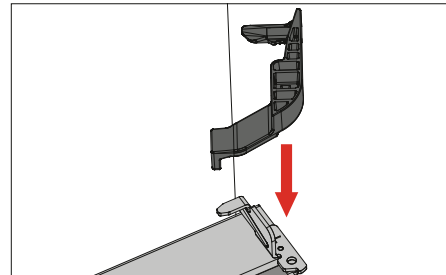

Rotate the lever to achieve the required adjustment

