



King Slide Ball Bearing Slides

King Slide has developed a reputation world wide for their high quality slides. The latest version of their side-mount soft-close ball-bearing slide is now available. This medium duty slide is designed for rigidity and ultra smooth motion. An improved soft-close function allows for a minimal opening force, creating less resistance and ultimately a superior experience.

Ensure your furniture drawers function to your own high standards with the new ball-bearing slide from King Slide!

Product Features

- Load Capacity: 45kg (100 lbs)
- Enhanced silent soft-closing feature with light opening force
- Ultra smooth gliding motion with high rigidity and stability
- Certified for 50,000 life cycles (ANSI/KCMA test standard)



NEW! Premium Medium Duty 45kg (100lb) load rating soft-close ball bearing slide.

Part#	Nominal Length	Box Qty
KS-3M52-12	300mm (12")	15
KS-3M52-14	350mm (14")	15
KS-3M52-16	400mm (16")	15
KS-3M52-18	450mm (18")	15
KS-3M52-20	500mm (20")	15
KS-3M52-22	550mm (22")	15
KS-3M52-24	600mm (24")	15
KS-3M52-26	650mm (26")	15
KS-3M52-28	700mm (28")	15

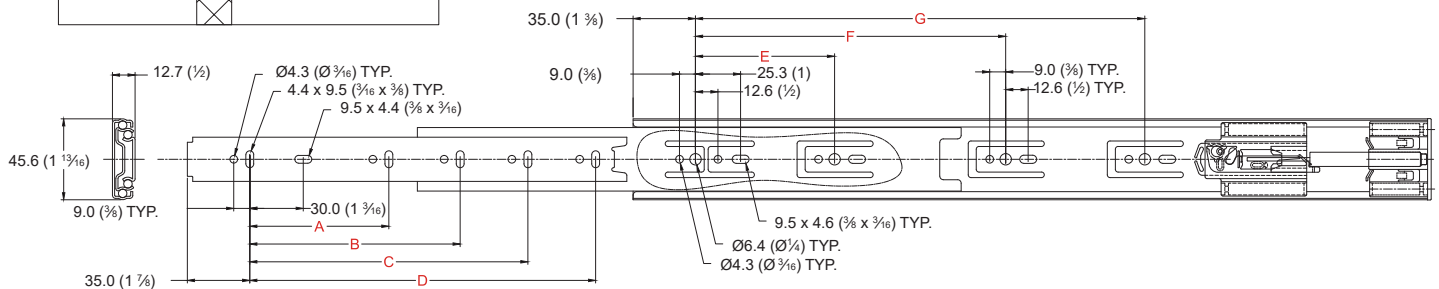
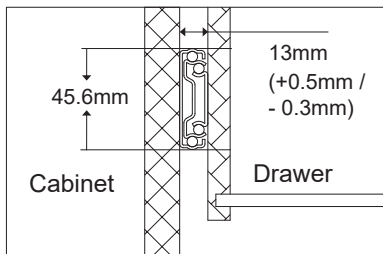

Note: Holes other than those shown are stamped for internal manufacturing purposes and may change without notice.

Part#	Slide Length mm (inch)	Slide Travel mm (inch)	Hole Positions mm (inch)						
			A	B	C	D	E	F	G
KS-3M52-12	302 (11 7/8)	285 (11 1/4)	96 (3 3/4)	--	--	--	96 (3 3/4)	--	--
KS-3M52-14	352 (13 7/8)	345 (13 5/8)	128 (5 1/4)	224 (8 13/16)	--	--	128 (5 1/4)	--	--
KS-3M52-16	402 (15 13/16)	400 (15 3/4)	128 (5 1/4)	256 (10 1/4)	--	--	128 (5 1/4)	192 (7 5/8)	--
KS-3M52-18	452 (17 13/16)	450 (17 3/4)	128 (5 1/4)	320 (12 5/8)	--	--	128 (5 1/4)	256 (10 1/4)	--
KS-3M52-20	502 (19 3/4)	500 (19 1/8)	128 (5 1/4)	224 (8 13/16)	352 (13 7/8)	--	128 (5 1/4)	256 (10 1/4)	--
KS-3M52-22	552 (21 13/16)	550 (21 3/4)	128 (5 1/4)	256 (10 1/4)	384 (15 1/4)	--	128 (5 1/4)	224 (8 13/16)	320 (12 5/8)
KS-3M52-24	602 (23 13/16)	600 (23 3/8)	128 (5 1/4)	288 (11 3/8)	416 (16 3/8)	--	128 (5 1/4)	224 (8 13/16)	352 (13 7/8)
KS-3M52-26	652 (26)	650 (25 1/2)	128 (5 1/4)	288 (11 3/8)	416 (16 3/8)	480 (18 3/4)	128 (5 1/4)	256 (10 1/4)	416 (16 3/8)
KS-3M52-28	702 (27 3/8)	700 (27 1/2)	128 (5 1/4)	320 (12 5/8)	448 (17 3/8)	544 (21 3/8)	128 (5 1/4)	320 (12 5/8)	480 (18 3/4)

For more information on **King Slide** Ball Bearing Slides, visit our website at www.marathonhardware.com

