



MARATHON

HARDWARE

EUREKA

LAGUNA

Technical Specifications



Technical Specifications

C-Shape Profile for Horizontal Between Drawers, 3m Length	
Part#	Finish
1683-AID-SS	Stainless Steel Look
1683-AID-MB	Matte Black
1683-AID-AN	Anodized Matte

Material: Aluminum
 Dimensions: 3000 x 73 x 26.5 mm

- Intended for between two drawers
- Cut to size with straight cuts only using a chop or mitre saw
- Quick install using clip connectors
- Profiles can be fitted with end caps or by your end panels
- Base cabinets need to be routed out to fit profiles



Dimensions

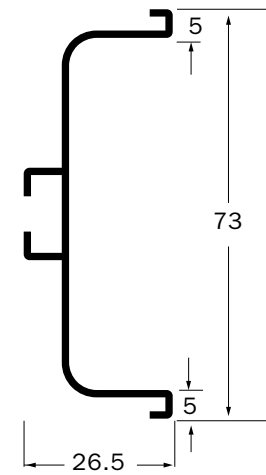

Base Cabinet Side

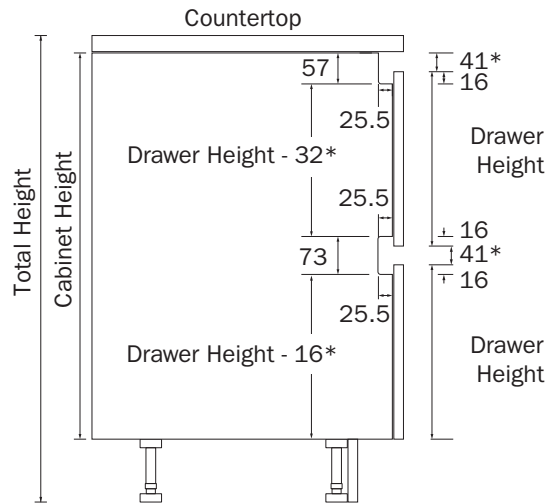

$$\text{Door Heights} = (\text{Cabinet Height} - 82^*) \div 2$$

* Recommendation based upon two equal drawers.
 Adjust accordingly. Minimum Gap Suggested 30mm.

Fixing Details

For Dowel: $\varnothing 5$
 Screw-On available

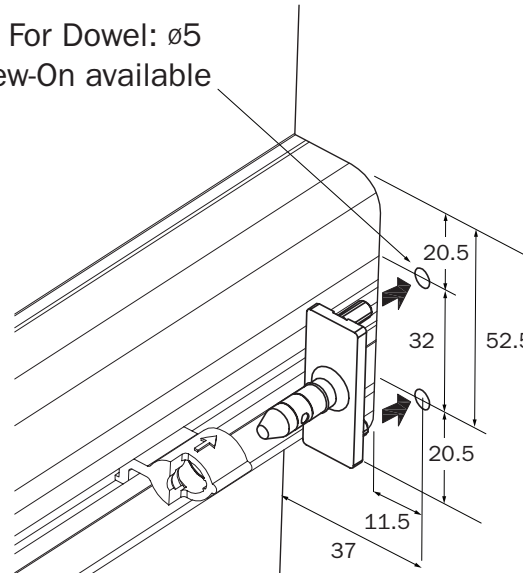

Routing Details

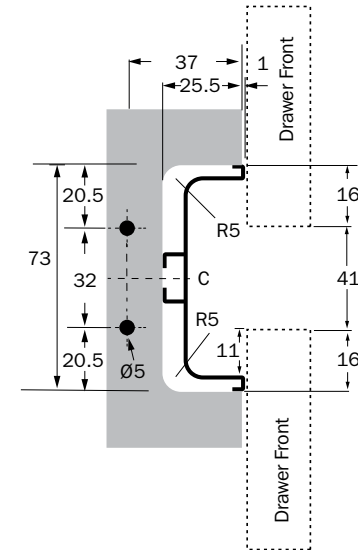

Suggested reveal between drawer fronts is 41mm.
 Minimum suggested between fronts is 30mm.
 Suggested overlap is 11mm for comfortable grip.

L-Shape Profile Profile for Horizontal Under Countertops, 3m Length

Part#	Finish
1682-AUC-SS	Stainless Steel Look
1682-AUC-MB	Matte Black
1682-AUC-AN	Anodized Matte

Material: Aluminum

Dimensions: 3000 x 57 x 26.5 mm

- For under the countertop both above doors or top drawers
- Cut to size with straight cuts only using a chop or mitre saw
- Quick install using clip connectors
- Profiles can be fitted with end caps, covered by your end panel or joined at corners using special inside/outside corner joint connectors
- Base cabinets need to be routed out to fit profiles



Dimensions

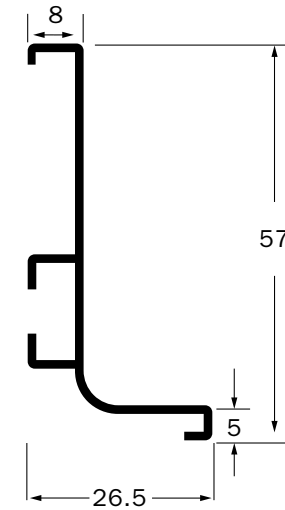

Base Cabinet Side

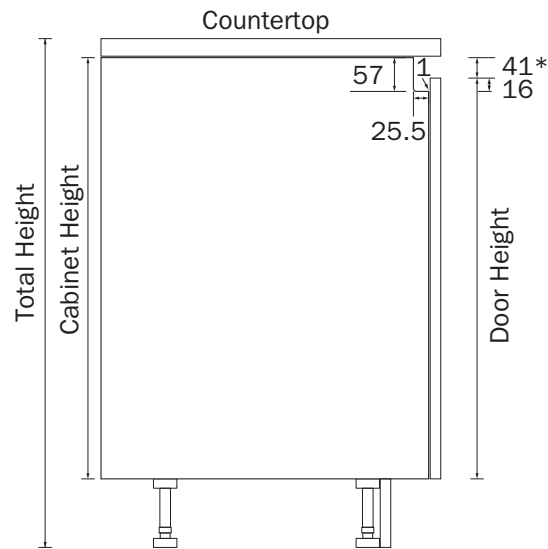

Door Height = Cabinet Height - 41mm

* Recommended Dimensions.
Minimum Gap Suggested 30mm.

Fixing Details

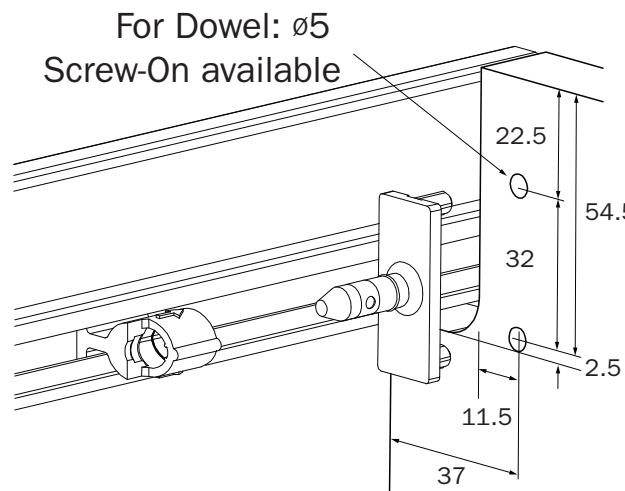

Routing Details

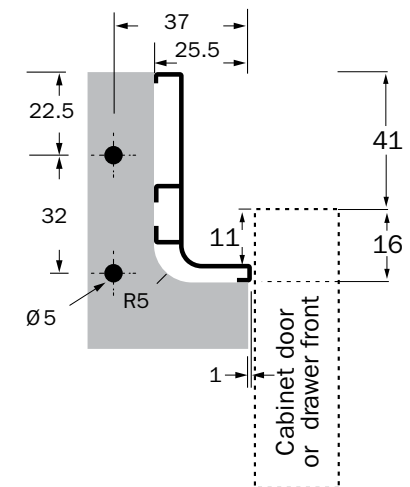

Suggested reveal between drawer fronts is 41mm.
Minimum suggested between fronts is 30mm.
Suggested overlap is 11mm for comfortable grip.

Technical Specifications

Profile for Vertical Double Doors. 3m Length	
Part#	Finish
1684-AV2-SS	Stainless Steel Look
1684-AV2-MB	Matte Black
1684-AV2-AN	Anodized Matte

Material: Aluminum
Dimensions: 3000 x 73 x 26.5 mm

- Used with tall cabinets where two opening doors meet
- Cut to size with straight cuts only using a chop or mitre saw
- Install to gable with wood screws
- Use Spacer kits to maintain 30mm gap
- Add both shims from Shim Kits to Spacer Kits when using 16mm (5/8") Panels



Dimensions

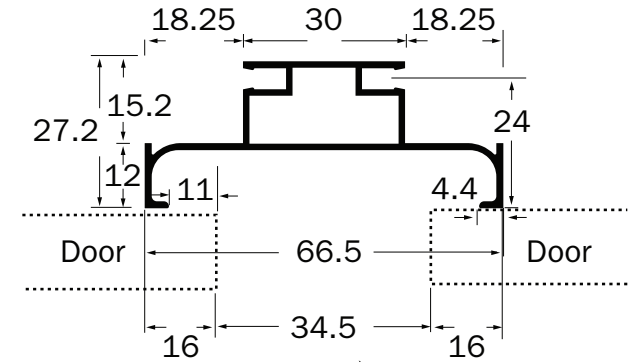

Suggested overlap is 11mm for comfortable finger grip.

Minimum suggested reveal between doors is 30 mm.

Application - Two Vertical Doors

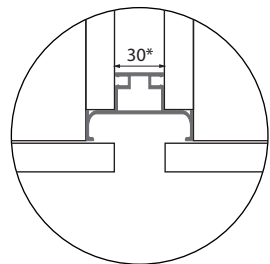
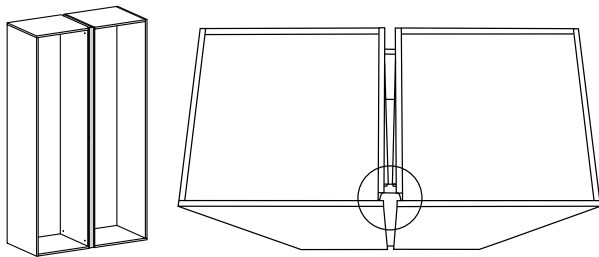

*Spacer Kit is for gap of 30mm and 18mm Panels.

Use with Shim Kit for 16mm (5/8") Gables.

Use of Spacer and Shim Kits

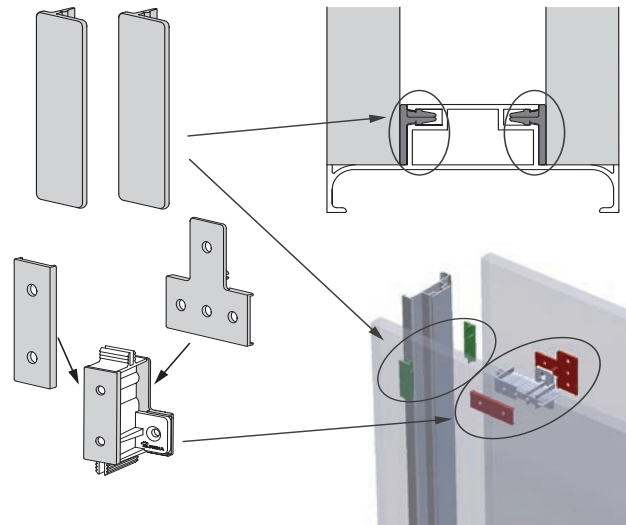

Fixing Details

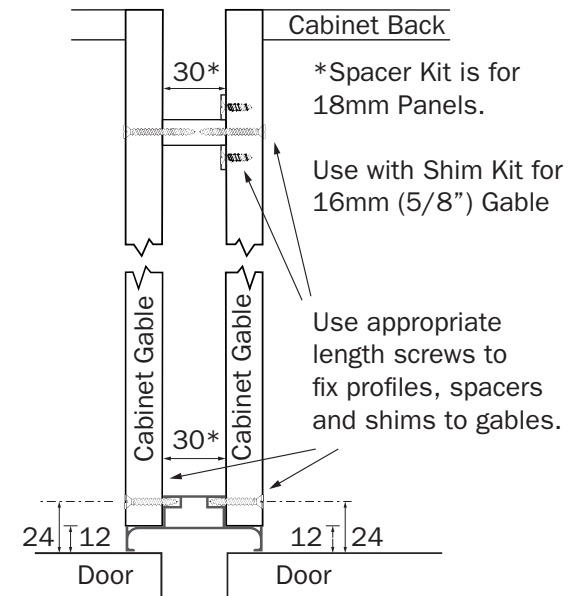

Profile for Vertical Door and End Panel. 3m Length

Part#	Finish
1685-AV1-SS	Stainless Steel Look
1685-AV1-MB	Matte Black
1685-AV1-AN	Anodized Matte

Material: Aluminum
 Dimensions: 3000 x 48 x 37 mm

- Used for single vertical opening doors where end panel fitted beside
- Cut to size with straight cuts only using a chop or mitre saw
- Install to gable with wood screws
- Use Spacer Kits to maintain 30mm gap
- Add 1 side shims from Shim Kits with Spacer Kits for 16mm (5/8") panels.

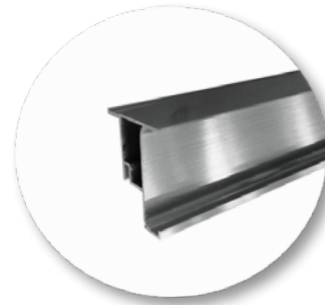

Dimensions

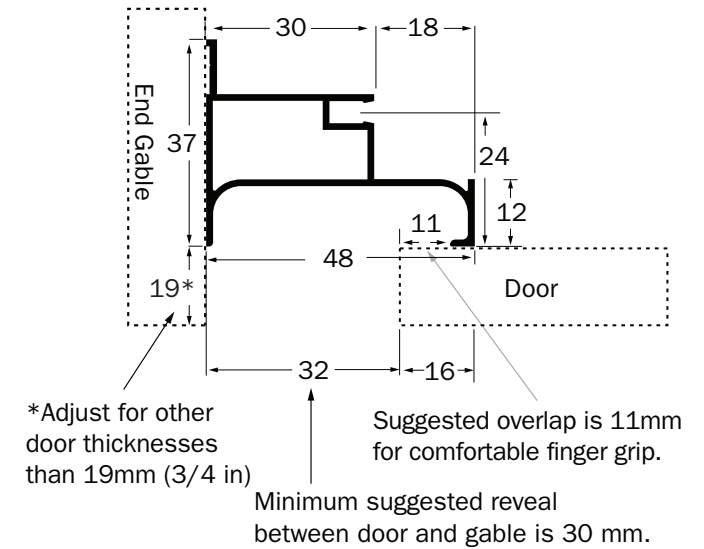

Application - One Vertical Doors & End Panel

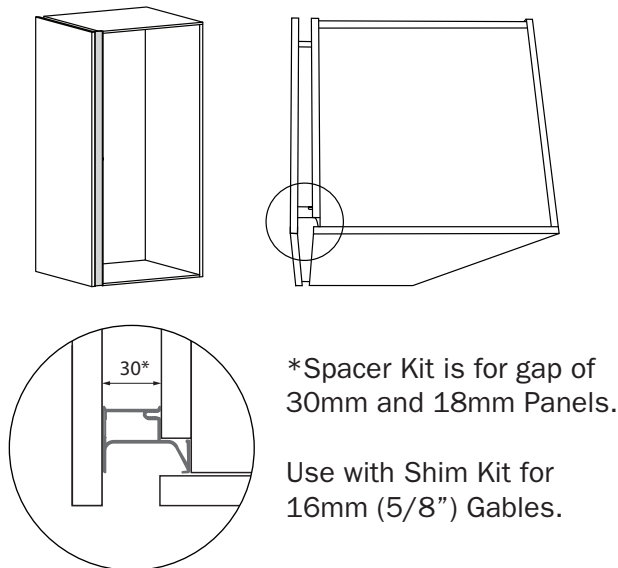

Use of Spacer and Shim Kits

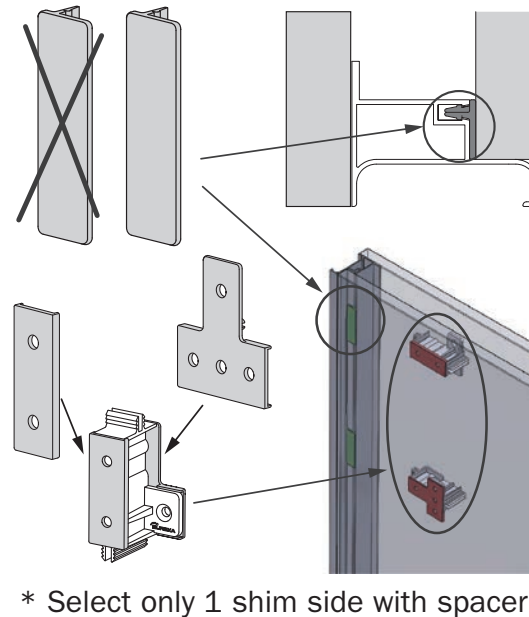

Fixing Details

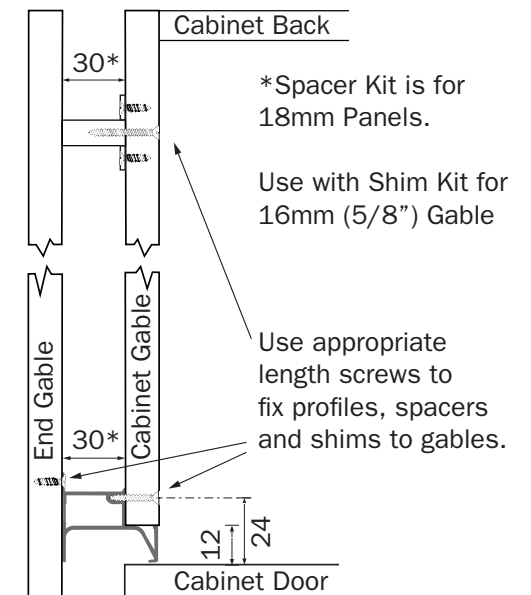

Technical Specifications

Upper Cabinet Profile, for Behind Door on 16mm Panel, 3m Length	
Part#	Finish
1645-2APC-SS	Stainless Steel Look
1645-2APC-MB	Matte Black
1645-2APC-AN	Anodized Matte

Material: Aluminum
Dimensions: 3000 x 26.5 x 16mm

- Concealed profile used on upper cabinets behind door
- Cut to size with straight cuts only using a chop or mitre saw
- Remove 16mm from bottom panel and push to install with adhesive
- Fits over 16mm (5/8") panels only
- No need to cut extra slot in bottom panel for fitting



Dimensions

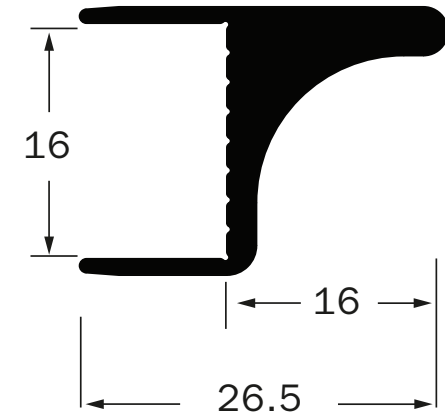

Application and Installation

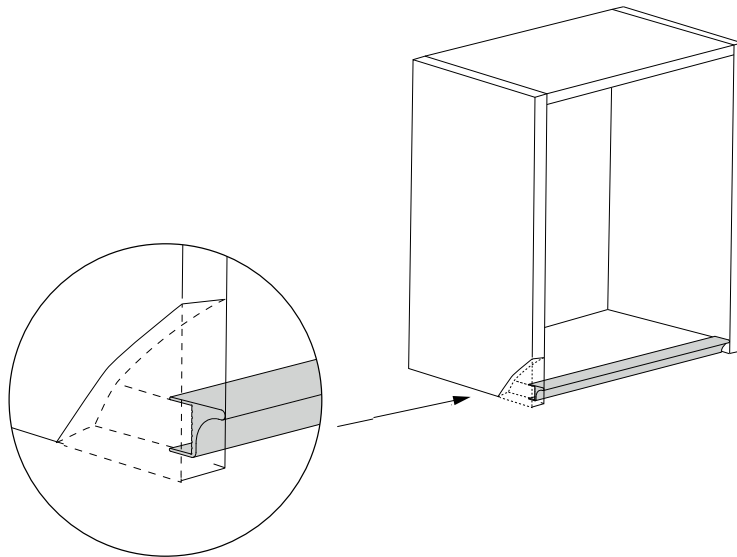

Installation Instructions

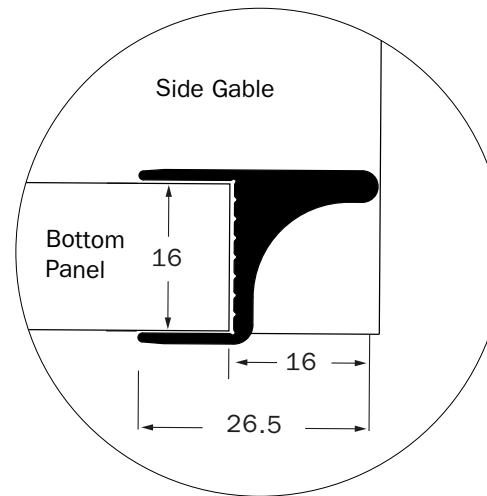

Remove 16mm from bottom panel inside cabinet that sits behind cabinet door.

Push profile over cut end and apply adhesive to securely fasten.

No need to further edgeband bottom panel or cut extra slots for fitting the profile to panel.

Mounting Clips for Horizontal Profiles

Part#	Description
1682-AP8	Mounting Clip, Screw-On
1682-AP9	Mounting Clip, Plastic Dowel (5mm)

Material: Plastic
 Dimensions: 37 x 15 x 23mm

- For Horizontal Base Cabinet Profiles only
- Screw-On or Plastic Dowel (5mm) versions
- Uses 32mm standard drillings (37x32mm)
- Fastens behind profile to end gable
- Slide receiving part into back of profile and quick snap together both pieces to securely fasten



Dimensions

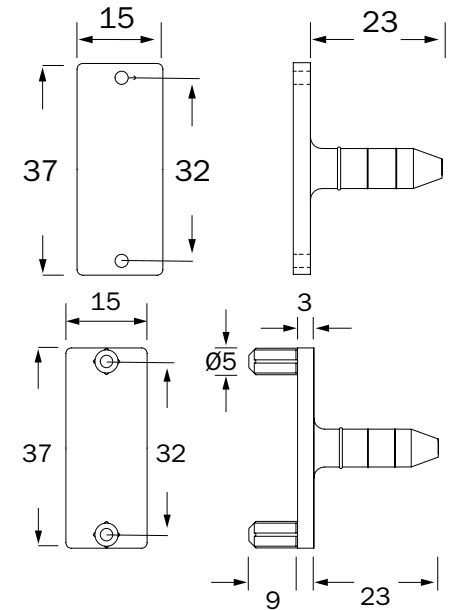

Assembly with Profiles

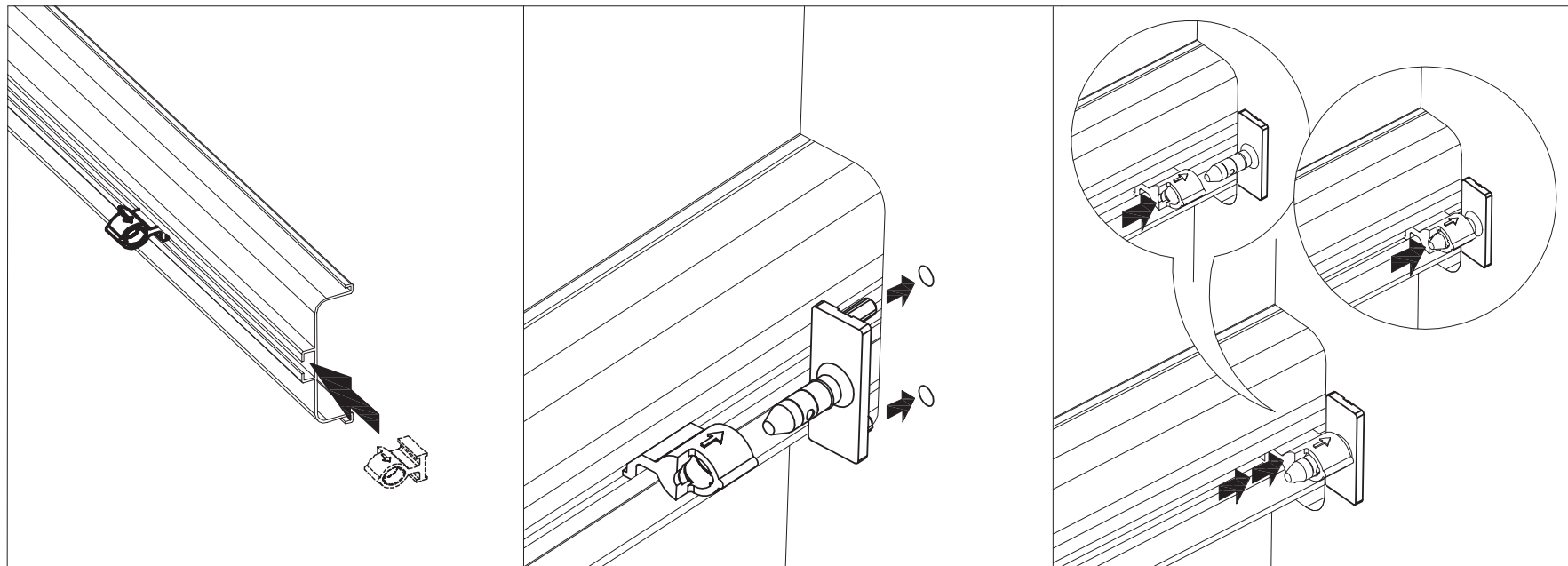

Technical Specifications

Corner Connector for Horizontal L-Shape Profile, Inside 90 Degrees

Part#	Finish
1682-AP4-SS	Stainless Steel Look
1682-AP4-MB	Matte Black
1682-AP4-AN	Anodized Matte

Material: Plastic
Dimensions: 27.5 x 27.5 mm

- Fits Horizontal L-Shape Below Countertop Profiles only
- Suits Straight Ends, Peninsula or Islands
- Connects Inside Corners, 90 Degrees
- Snap together with no fasteners needed
- No extra special machining work required



Dimensions

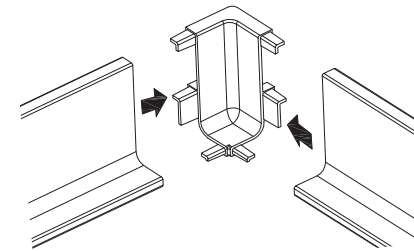
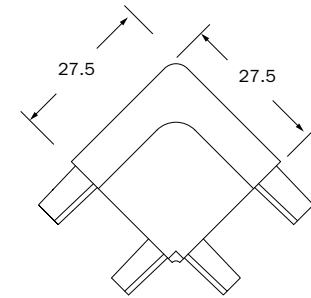

Fitting

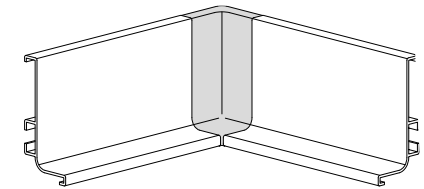

Corner Connector for Horizontal L-Shape Profile, Outside 90 Degrees

Part#	Finish
1682-AP5-SS	Stainless Steel Look
1682-AP5-MB	Matte Black
1682-AP5-AN	Anodized Matte

Material: Plastic
Dimensions: 26.5 x 26.5 mm

- Fits Horizontal L-Shape Below Countertop Profiles only
- Suits Straight Ends, Peninsula or Islands
- Connects Outside Corners, 90 Degrees
- Snap together with no fasteners needed
- No extra special machining work required



Dimensions

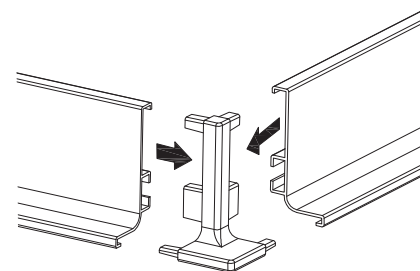
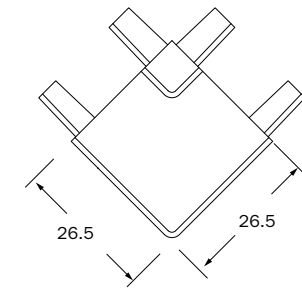

Fitting

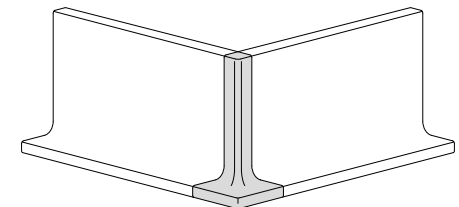

Open Cover Cap for L-Shape Profiles

Part#	Side	Finish
1682-AP1R-SS	Right	Stainless Steel Look
1682-AP1R-MB	Right	Matte Black
1682-AP1R-AN	Right	Anodized Matte
1682-AP1L-SS	Left	Stainless Steel Look
1682-AP1L-MB	Left	Matte Black
1682-AP1L-AN	Left	Anodized Matte

Material: Plastic
 Dimensions: 58 x 26.5 x 2.5 mm

- Trim profiles 2.5mm less than measured length to fit
- Use to cover profile cut ends
- Quick fit; push together

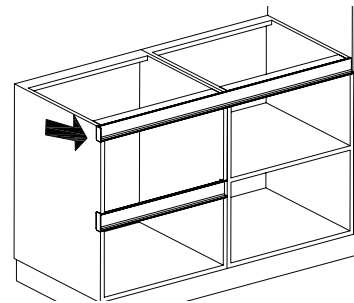

Dimensions

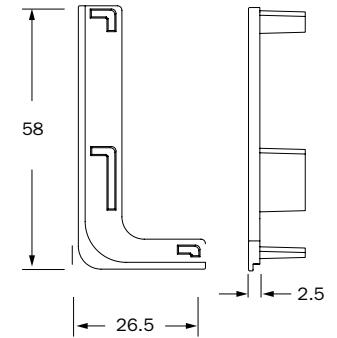

Fitting

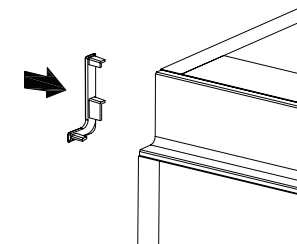

Closed Cover Cap for L-Shape Profiles

Part#	Side	Finish
1682-AP2R-SS	Right	Stainless Steel Look
1682-AP2R-MB	Right	Matte Black
1682-AP2R-AN	Right	Anodized Matte
1682-AP2L-SS	Left	Stainless Steel Look
1682-AP2L-MB	Left	Matte Black
1682-AP2L-AN	Left	Anodized Matte

Material: Plastic
 Dimensions: 58 x 26.5 x 2.5 mm

- Trim profiles 2.5mm less than measured length to fit
- Use to cover profile cut ends
- Quick fit; push together

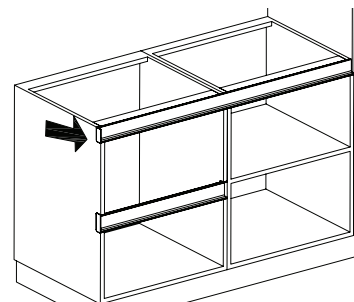

Dimensions

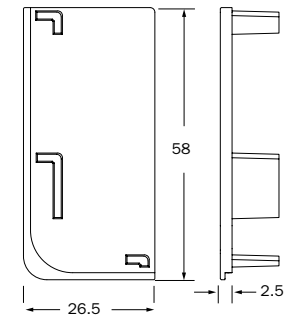

Fitting

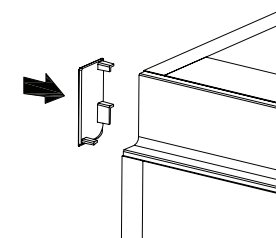

Technical Specifications

Open Cover Cap for C-Shape Profiles		
Part#	Side	Finish
1683-APIU-SS	Universal	Stainless Steel Look
1683-APIU-MB	Universal	Matte Black
1683-APIU-AN	Universal	Anodized Matte

Material: Plastic
Dimensions: 76 x 26.5 x 2.5 mm

- Trim profiles 2.5mm less than measured length to fit
- Use to cover profile cut ends
- Quick fit; push together

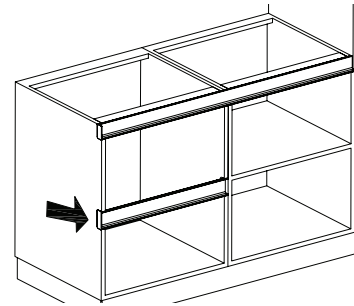

Dimensions

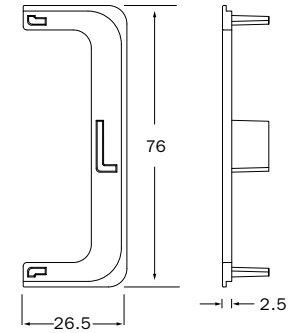

Fitting

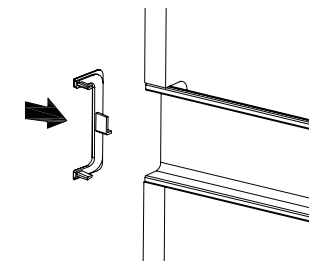

Closed Cover Cap for C-Shape Profiles		
Part#	Side	Finish
1683-AP2U-SS	Universal	Stainless Steel Look
1683-AP2U-MB	Universal	Matte Black
1683-AP2U-AN	Universal	Anodized Matte

Material: Plastic
Dimensions: 76 x 26.5 x 2.5 mm

- Trim profiles 2.5mm less than measured length to fit
- Use to cover profile cut ends
- Quick fit; push together

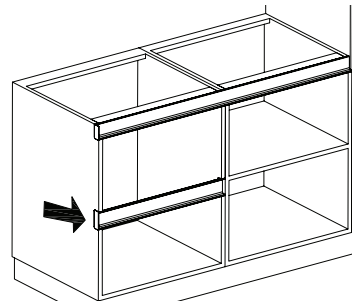

Dimensions

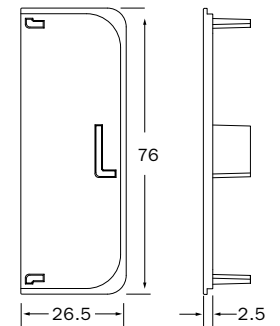

Fitting

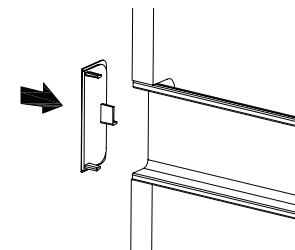

Vertical Profile Closed Cover Cap for Top/Bottom

Part#	Finish
1684-APITB-SS	Stainless Steel Look
1684-APITB-MB	Matte Black
1684-APITB-AN	Anodized Matte

Material: Plastic
 Dimensions: 66.5 x 12 x 1.1 mm

- Trim profiles 1.1mm less than measured length to fit
- Use to cover open top or bottom in vertical profiles
- Breakable tabs for left or right single door applications.
- Quick fit; push together

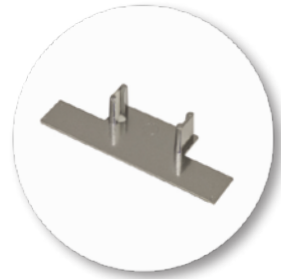

Dimensions

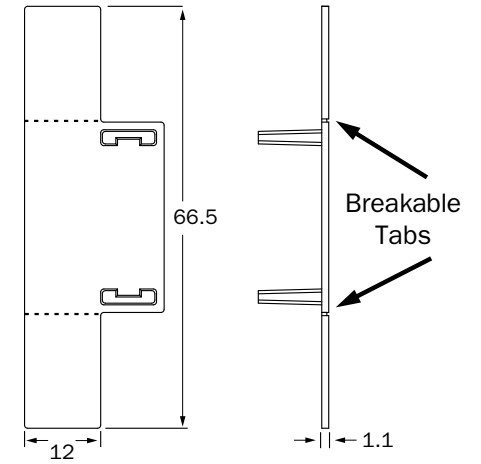

Fitting

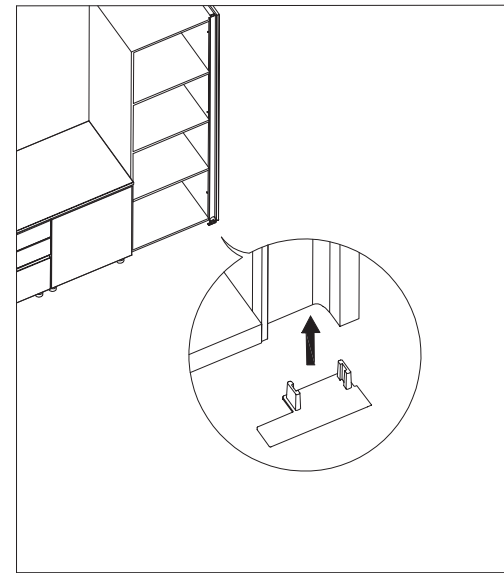
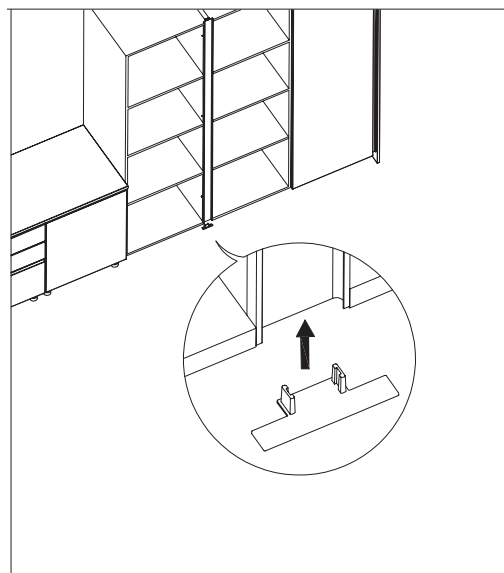



Quality . Innovation . Service

info@marathonhardware.com

800.840.1228

