



## Basic Cabinet Hardware Jig and Case

**Part Number: TP-1934**

Cabinet Hardware Jig + Case

Install Knobs and Handles without the tedious hours of measuring or making jigs  
– Fast, accurate hardware installation in seconds, every time.

### Product Description

Introducing the TP-1934, the most accurate and versatile hardware jig on the market.

Built for speed, this tool doesn't require marking or clamping. Created from a superior, hardened anodized aluminum that comes equipped with laser engraved rulers and case hardened bushings, its durability shockingly isn't its greatest feature. Supported by a money back guarantee, the TP-1934 delivers a proven, step-by-step formula of accuracy, saving anyone who uses it from costly replacement do-over's.

True Position Tools has invested heavily in designing the tool so both professional tradesmen and DIY'ers alike can realize the benefits after just one project. Our customers have been delighted to recognize the hours of labor and cost savings that result in just their first project, by using our product instead of other methods or instruments.

### Product Advantages

- Install handles up to 300mm (12 inches) Centre to Centre
- Most accurate & fastest on the market!
- Versatile - Hinge Plates + Shelf Pin holes
- Calibrated to .001 square, Precision Guarantee
- Bushings backed by Lifetime Warranty

### Included Products

- T-Square w/ Center Bushing
- Large Stop
- 2x Sliding Drill Guides
- Sliding End Stop
- 5mm Drill Bit
- Blow Molded Carrying Case

Technical Documents

### USING EXTENDED RULER ATTACHMENT (TP-ERA) ON DRAWER



For fast repeatability use the Extended Ruler Attachment

Align each ruler at the 3" mark to extend the length of ruler to 12"

Measure drawer width

Set small end stop to half the drawer width

Now you are ready to drill on entire drawer bank

Perfectly placed

Everytime

If your handle pattern interferes with double bracketed move below in square and connect the 3" ruler at the 3" mark as pictured above

### LARGE HANDLE ON WIDE DRAWER FRONT



We demonstrate a method to center a long pull on a Drawer - line up center of one hole with edge of Drawer.

Measure from left of drawer to center of left hole on hardware. Use half this to set for the sliding stop end on the end.

Mark selected drill bushing with tape on extension (included in TP-2512, TP-1923)

Adjust end stop at desired distance from the marked bushing

Lay the pull on the jig align with top hole

Now mark the other hole with tape

Measure height of drawer use half that number for center

Set the Large Stop and tighten at desired location

Hold stops firm against top and left side of drawer and drill your holes

Long hardware installed



## TRUE POSITION TOOLS

A guide to using True Position Tools Hardware Jigs

- Always secure sliding guides and stops in position and tighten before drilling.
- Be sure to wear proper safety gear when using power tools
- Make sure hands are out of the way when drilling

See more [www.truepositiontools.com](http://www.truepositiontools.com)

### KNOB ON DOOR INSTALLATION



Place hardware to find the position you like

Measure from bottom mark position with pencil

Measure from side

Match the sliding end stop with your bottom measurement and tighten

Match Large Stop to your side measurement and tighten

Position tool with stops as shown and drill hole through drill bushing

Reverse tool position onto opposite door and drill

SCAN FOR WEB INSTRUCTIONS



### HANDLE ON DOOR INSTALLATION



Place hardware to find position you like

Measure from bottom mark position with pencil

Measure from side

Measure hole centers of your hardware

Transfer your hardware measurement to the sliding drill bushing and tighten

Match bottom measurement with sliding end stop and tighten.

Match side measurement to Large Stop and tighten

Position tool as shown drill through fixed center bushing for bottom hole

Drill through top sliding bushing for top hole

Reverse tool position onto opposite door and drill holes

View this product online at <https://marathonhardware.com/pd/TP-1934>

Technical Documents



**1** Set Hardware Spacing



**2** Adjust Location

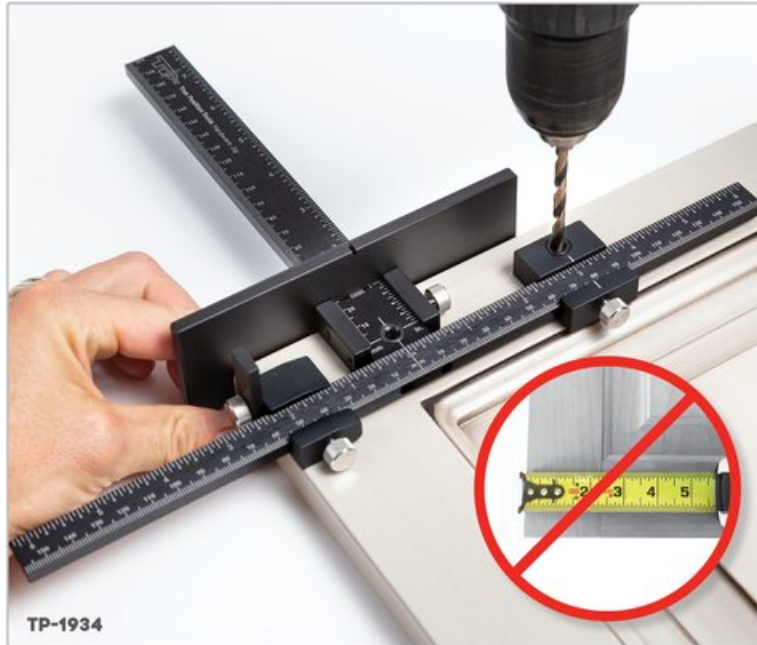

TP-1934

**3** Hold & Drill

View this product online at <https://marathonhardware.com/pd/TP-1934>

Technical Documents

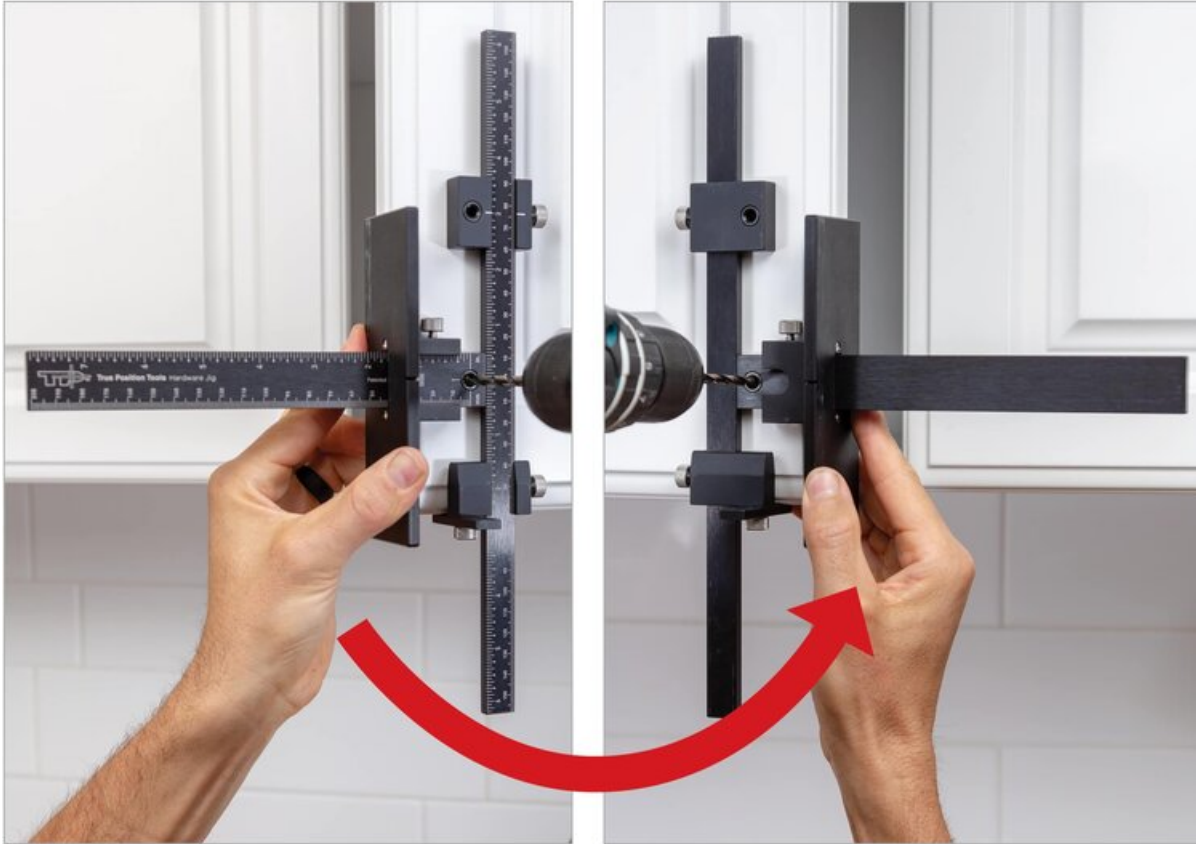

View this product online at <https://marathonhardware.com/pd/TP-1934>

